

# GRORICH PATIO BLINDS



# GRORICH PATIO BLINDS AT ST.REGIS, MALDIVES







# GRORICH PATIO BLINDS AT WESTIN HOTEL, HYDERABAD







8mtr x 9mtr  
motorized  
blinds



# view from the inside





# GRORICH PATIO BLINDS-GEARED TYPE [EXTERIOR VIEW]



# GRORICH PATIO BLINDS VIEW FROM SIDE AND REAR





# GRORICH PATIO SCREEN [ MOTORISED ] WITH FERRARI-502 FABRIC



# GRORICH JUMBO [5MTR WIDE X 4MTR HT.] RETRACTABLE PATIO SCREEN- MOTORISED





# Grorich Patio Blinds at Brigade Orion Mall, Bangalore.

**Drawn up Patio Blinds**



**Drawn Down Patio Blinds**



# Brigade Orion Mall, Bangalore.

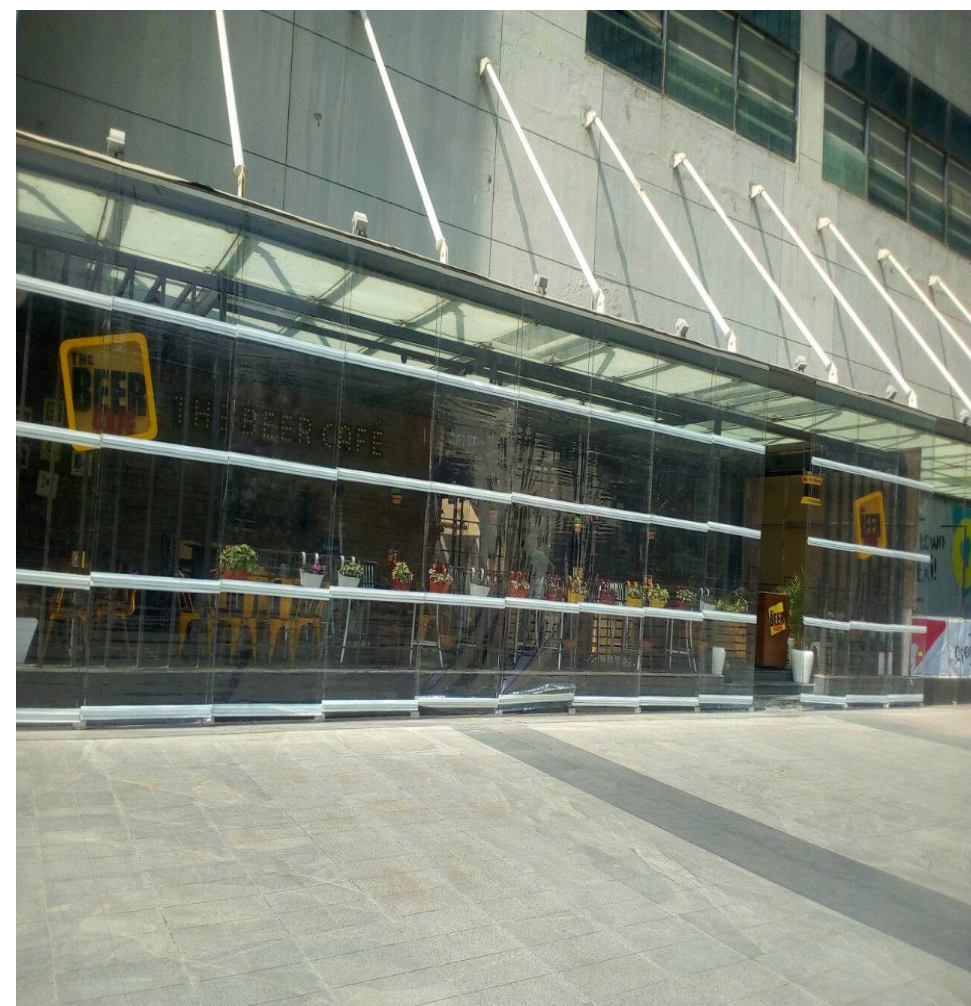



# CONSTRUCTION DETAIL OF A TYPICAL GRORICH MOTORISED PATIO BLINDS

## Grorich

External Patio/Roller Blind

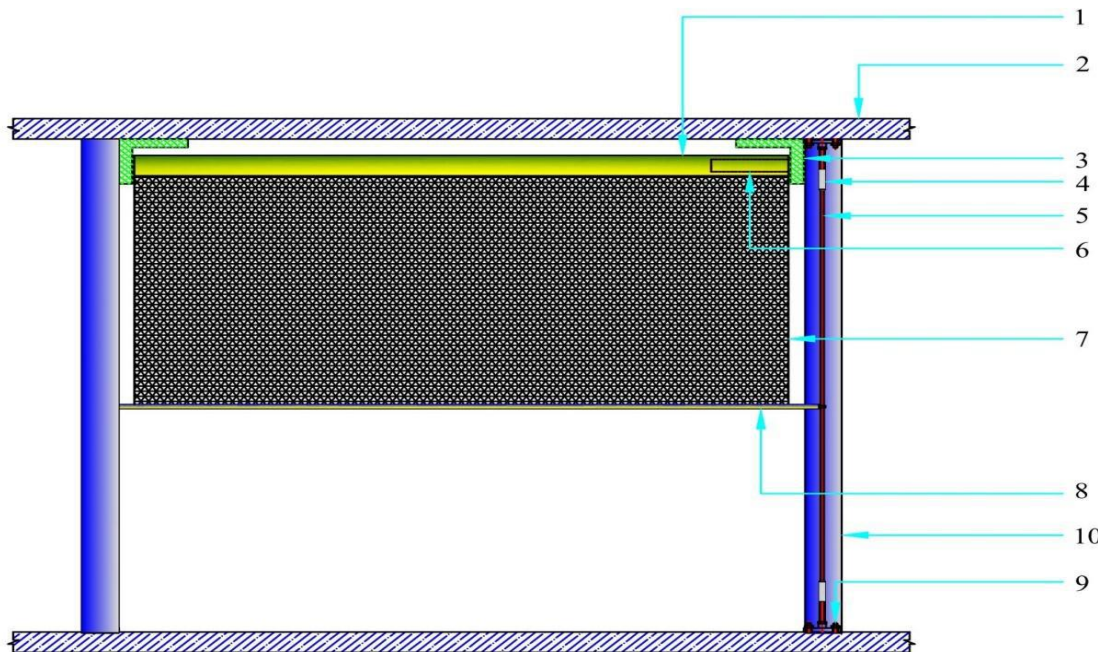

1. FABRIC HOLDER
2. RCC/WOOD CEILING TO ANCHOR SIDE BRACKET
3. TUBULAR MOTOR SIDE BRACKET
4. TERMINAL
5. WIRE ROPE
6. TUBULAR MOTOR
7. ROLLER SCREEN-FABRIC
8. BOTTOM BAR WITH WIRE ROPE GUIDE
9. WIRE ROPE TENSION SYSTEM
10. OPTIONAL METAL COVER FOR WIRE ROPE TENSION SYSTEM



# CONSTRUCTION DETAIL OF A TYPICAL GRORICH MANUAL PATIO BLINDS (VELCRO)

PATIO BLIND (VELCRO) EXPLODED VIEW

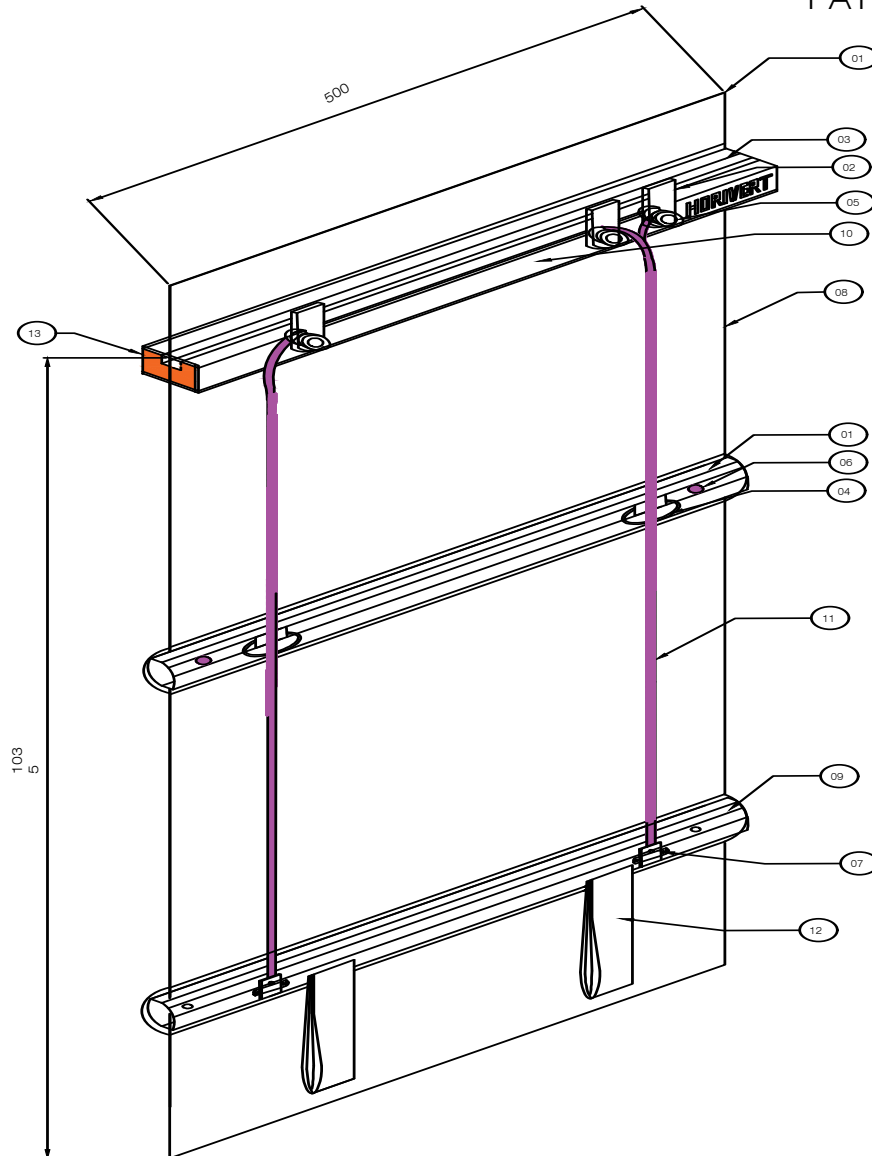

01	INTERMEDIATE BAR
02	FABRIC HOLDER
03	HEAD RAIL& FABRIC HOLDER
04	CORD GUIDE RINGS
05	CORD GUIDE PULLEY & HOLDER
06	ANTI NOISE RUBBER
07	CORD TERMINAL HOLDER
08	Ø.5/0.8 CLEAR PVC
09	BOTTOM BALANCER
10	TOP BALANCER
11	SMM CORD
12	WELL CRAFT STRAP
13	END CAP



# CONSTRUCTION DETAIL OF A TYPICAL GRORICH MANUAL PATIO BLINDS

## PATIO BLINDS



GRORICH HORIVERT PVT.LTD  
BANGALORE

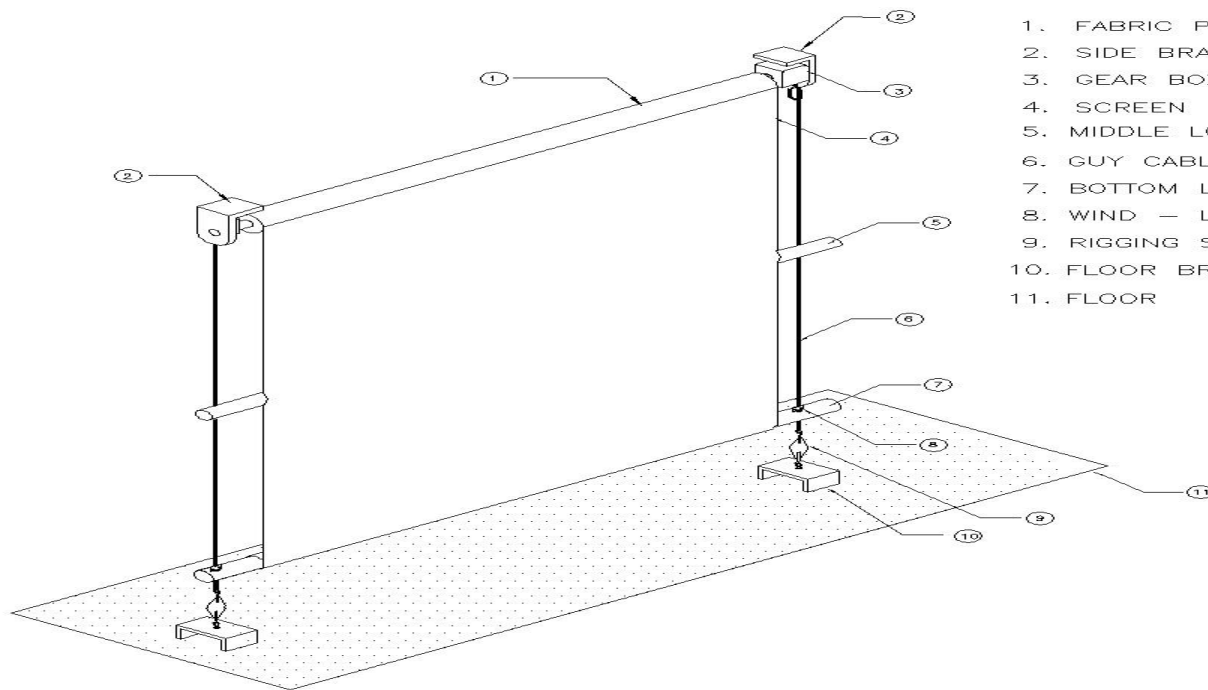

1. FABRIC PIPE
2. SIDE BRACKETS
3. GEAR BOX WITH TILTER
4. SCREEN
5. MIDDLE LOAD BAR (OPTIONAL)
6. GUY CABLE
7. BOTTOM LOAD BAR
8. WIND - LOCK
9. RIGGING SCREW
10. FLOOR BRACKET
11. FLOOR



# GRORICH PATIO BLINDS TECH SPECS

- SUPPLY AND INSTALLATION OF RAIN PROTECTION SYSTEM WITH 63MM DIA COATED ALUMINIUM EXTRUDED FABRIC PIPE HAVING 4MMX4MM GREW PROFILE FOR RAIN-SCREEN INSERTION AND WALL THICKNESS OF 1.6-2MM FOR OPTIMUM STRENGTH.
- THE BEST SUGGESTED SCREEN FOR THIS PURPOSE BEING FERRARI-SOLTIS-AIR;HOWEVER ANY PVC/TEFLON COATED FABRIC, SUITABLE FOR OUTDOOR SHADING PURPOSES CAN BE RECOMMENDED.FABRIC WEIGHT SHOULD BE MINIMUM 380-400GSM AND SHOULD HAVE FAST UV-STABILISED COLOR COATING.FABRIC SHOULD BE WITH OPEN FACTOR OF MINIMUM 3-6% FOR AIR-PERMEABILITY AND STRUCTURAL STABILITY.
- SHOULD THERE BE AN INSISTANCE TO USE THE NON-PERMEABLE FABRICS,PROPOER AIR-VENT SHOULD BE ENSURED TO ACHIEVE THE ABOVE OBJECTIVE.
- BOTTOM LOAD BAR SHOULD BE POCKET WELDED AT THE BOTTOM OF THE RAIN-SCREEN WEIGHING NOT LESS THAN 500GMS/MTR AND TO GUIDE THRU THE GUY-CABLES/POSTS.GUY CABLES OR POSTS SHOULD BE 6-8MM STAINLESS STEEL MATERIAL OF CONSTRUCTION.GUY CABLE/POSTS ARE FIXED BETWEEN THE TOP FABRIC PIPE AND BOTTOMLOAD-BAR AND INDEPENDENT OF THESE TWO.
- THE SYSTEM TO BE PROVIDED WITH WIND-LOCKS ABOVE THE LOAD-BAR AND GUY-CABLE.INTERMEDIATE WIND-BARS ARE OPTIONAL.

## **MANUAL OPERATION:**

- THE RETRACTION AND DROPPING OF THE SCREEN IS ACHIEVED BY GEARED HOUSING FITTED TO ONE END OF THE FABRIC PIPE AND THE OTHER END TO HAVE THE IDLER;BOTH THE IDLER AND OPERATING GEAR-HOUSING ARE FURTHER SUSPENDED BETWEEN END-BRACKETS MADE EITHER OF ENGG. PLASTICS OR METAL BRACKETS.
- MANUAL CHAIN OPERATED SYTEM IS AVAILABLE TOO.

## **MOTORISED OPERATION :**

- 50MM OR 60MM TUBULA MOTORS ARE RECOMMENDED DEPENDING UPON THE SPAN TO BE COVERED.THE MAXIMUM SPAN FOR MOTORISED OPERATION WILL BE 9TRX9MTRS WITH INTERMEDIATE COUPLINGS AT EVERY 3-4 MTRS. MOTORS CAN BE EITHER SWITCH CONTROLLED, REMOTE CONTROLLED OR SYSTEM INTEGRATED.





# GRORICH HORIVERT PVT. LTD.

*Symphony of Shades*

Address : #49/2, Muthurayaswamy layout,  
Srigandharakaval, Sunkadakatte, Magadi Road, Bangalore -  
560 091. India

Phone: +91 9845043292/ +91 9980043292

Email: [info@grorichhorivert.com](mailto:info@grorichhorivert.com)

[www.grorich.in](http://www.grorich.in)